

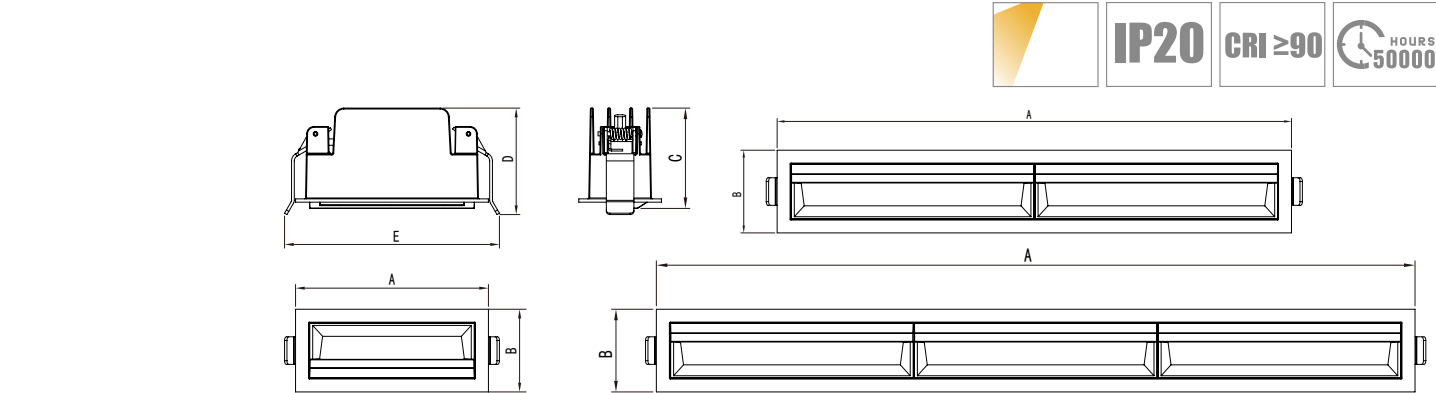



Technical Data Sheet

Code No.			BL020015-105-9W	BL020015-147-13W	BL020015-280-25W	BL020015-413-37W
Dimension(mm)			105×45×55	147×45×55	280×45×55	413×45×55
Cutout (mm)			97×37	139×37	272×37	405×37
Watt(W)			9W	13W	25W	37W
Rated Input Voltage(V)			AC220-240V			
Input Voltage(V)			AC220V			
LED Module Input			DC9V 700mA	DC15V 700mA	DC30V 700mA	DC45V 700mA
Light Source			SMD			
SDCM			<6			
CCT(K)			1-CCT: 2700K/3000K/4000K			
CCT Selection DIP Switch			NO			
Luminous Flux (lm) ±5%	Non-DIM	1-CCT	280-380LM	470-690LM	930-1300LM	1400-2000LM
	DIM		-			
	Non-DIM	3-CCT	-	-	-	-
	DIM		-			
CRI			Ra>90			
Beam Angle (°)			70°x90°x10°			
UGR			-			
LED Driver			Built-out			
Dimming Option			Triac/ DALI/ 0-10V			
Sensor			-			
Emergency Kits			-			
Electrical Class			Class II			
Ingress Protection (IP Rating)			IP20(Inside Ceiling)			
Impact Resistance (IK Rating)			IK06			
Product Finishing(Base)			White 9003, Black 9005			
Materials of Optics			PC			
Materials of Housing			Aluminum			
Lifetime (hr)			50,000h			
Glow wire test (℃)			750℃			
Operating Temp. (℃)			-20℃ ～45℃			
Storage Temp. (℃)			-20℃ ～65℃			
Installation			Recessed			



Measurement

Code	Dimension(mm)					Size(mm)	Product Weight (Kg)		Package weight (Kg)		Carton Size(cm)	Qty/ CTN	20GP (pcs)	40HQ (pcs)
	A	B	C	D	E		N.W/PC	G.W/PC	N.W/CTN	G.W/CTN				
BL020015-105-9W	105	45	55	58	117	105x45x55	0.21	0.31	15.5	16.4	59.5x31.5x43	50	17100	40950
BL020015-147-13W	147	45	55	58	159	147x45x55	0.27	0.37	14.8	15.7	67x32.5x37	40	14160	34440
BL020015-280-25W	280	45	55	58	292	280x45x55	0.51	0.64	12.8	13.5	49x32.5x37	20	9720	23800
BL020015-413-37W	413	45	55	58	425	413x45x55	0.7	0.9	18	18.9	62.5x32.5x37	20	7560	18620

Driver Datasheet (Non-dimmable)

Total load wattage		9W	13W	25W	37W
Output	Output Voltage range	8-12V	9-16V	25-34V	36-51V
	Rated output current	700mA			
	Line Regulation	±5%			
	Setup, Rise Time	0.5S			
	Flickering Index	1.5%			
Input	Input Voltage	AC 198-264V			
	Rated Input Voltage(V)	AC 220-240V			
	Frequency	50/60 Hz			
	Input Current	160mA	160mA	150mA	220mA
	Rated Input Current	82mA	121mA	127mA	193mA
	Power Factor	0.5	0.5	0.90	0.90
	THD	-		≤15%(230V)	
	Efficiency	78%	78%	88%	89%
	No load wattage	<0.5W			
Protection	Short circuit protection	Pass			
	Over voltage protection	Pass			
	Over temperature protection	Pass			
Safety &EMC	Withstand voltage	I/P-O/P:3KVac, <5mA 60S			
	Isolation Resistance	I/P-O/P:500VDC, ≥100M Ω			
	Surge	IEC/EN61000-4-5(L-N:1KV)			
	EMC Emission	EN55015, EN61000-3-2			
	EMC Immunity	EN61000-4-2,3,4,5,6,8,11; EN61547			

Driver Datasheet (Triac Dimmable)

Total load wattage		9W	13W	25W	37W
Output	Output Voltage range	8-14V	12-20V	26-42V	30-52V
	Rated output current	700mA			
	Line Regulation	± 5%			
	Setup, Rise Time	≤0.5S (230VAC)			
	Flickering Index	1.5%			
Input	Input Voltage	AC 198-264V			
	Rated Input Voltage(V)	AC 220-240V			
	Frequency	50/60 Hz			
	Input Current	80mA	100mA	160mA	220mA
	Rated Input Current	46mA	66mA	127mA	187mA
	Power Factor	0.90			
	THD	-		≤20% (230VAC)	
	Efficiency	78%	81%	86%	87%
	No load wattage	≤0.5W @230VAC			
Protection	Short circuit protection	Pass			
	Over voltage protection	Pass			
	Over temperature protection	Pass			
Safety &EMC	Withstand voltage	I/P-O/P:3.75KVac, <5mA 60S			
	Isolation Resistance	I/P-O/P: 500VDC, ≥100M Ω			
	Surge	IEC/EN61000-4-5(L-N:1KV)			
	EMC Emission	EN55015, EN61000-3-2			
	EMC Immunity	EN61000-4-2,3,4,5,6,8,11; EN61547			

Driver Datasheet (0-10V Dimmable)

Total load wattage		9W	13W	25W	37W
Output	Output Voltage range	3-84V			
	Rated output current	700mA			
	Line Regulation	± 3%			
	Setup, Rise Time	≤0.5S (230VAC)			
	Flickering Index	1.5%			
Input	Input Voltage	AC 180-264V			
	Rated Input Voltage(V)	AC 200-240V			
	Frequency	47-63 Hz			
	Input Current	300mA			
	Rated Input Current	50mA	73mA	139mA	206mA
	Power Factor	0.90			
	THD	≤20% (230VAC)			
	Efficiency	89%			
	No load wattage	≤0.5W @230VAC			
Protection	Short circuit protection	Pass			
	Over voltage protection	Pass			
	Over temperature protection	Pass			
Safety &EMC	Withstand voltage	I/P-O/P:3.75KVac, <5mA 60S			
	Isolation Resistance	I/P-O/P: 500VDC, ≥100M Ω			
	Surge	IEC/EN61000-4-5(L-N:2KV)			
	EMC Emission	EN55015, EN61000-3-2			
	EMC Immunity	EN61000-4-2,3,4,5,6,8,11; EN61547			

Driver Datasheet (DALI Dimmable)

Total load wattage		9W	13W	25W	37W
Output	Output Voltage range	3-84V			
	Rated output current	700mA			
	Line Regulation	± 3%			
	Setup, Rise Time	≤0.5S (230VAC)			
	Flickering Index	1.5%			
Input	Input Voltage	AC 180-264V			
	Rated Input Voltage(V)	AC 200-240V			
	Frequency	47-63 Hz			
	Input Current	300mA			
	Rated Input Current	50mA	73mA	139mA	206mA
	Power Factor	0.90			
	THD	≤20% (230VAC)			
	Efficiency	78%			
	No load wattage	≤0.5W @230VAC			
Protection	Short circuit protection	Pass			
	Over voltage protection	Pass			
	Over temperature protection	Pass			
Safety &EMC	Withstand voltage	I/P-O/P:3.75KVac, <5mA 60S			
	Isolation Resistance	I/P-O/P: 500VDC, ≥100M Ω			
	Surge	IEC/EN61000-4-5(L-N:2KV)			
	EMC Emission	EN55015, EN61000-3-2			
	EMC Immunity	EN61000-4-2,3,4,5,6,8,11; EN61547			

Installation Procedure

WARNING ⚡

- 1.Switch off before installation / maintenance.
- 2.Switch on only after complete installation and examination of the circuit.
- 3.Professional electrician for installation and maintenance only.

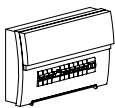

Turn Off power supply before starting any installation. Read instructions & check you have all the tools & accessories to complete the installation correctly.

Type B Asymmetric washer light

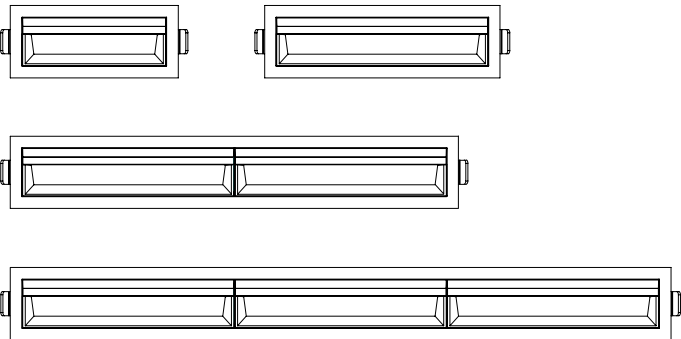

Step 1

Open a hole according to the cutout size of the lamp.

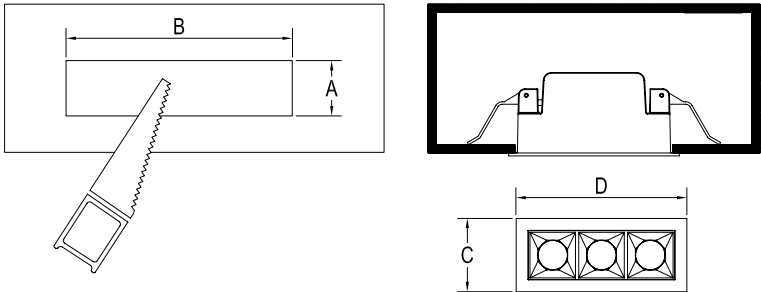

AxB mm	CxDmm
37x37	45x45
68x37	76x45
97x37	105x45
67x67	75x75
139x37	147x45
97x97	105x105
272x37	280x45
405x37	413x45

Step 2

Remove the driver cover, do wire connection accordingly, then fix the driver cover.

2.1 Non-dimmable driver

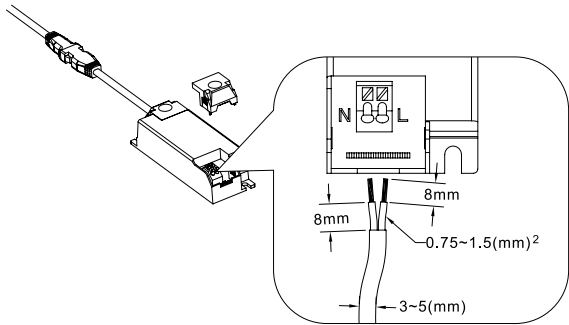

2.2 RPC triac dimmer(10%-100%)

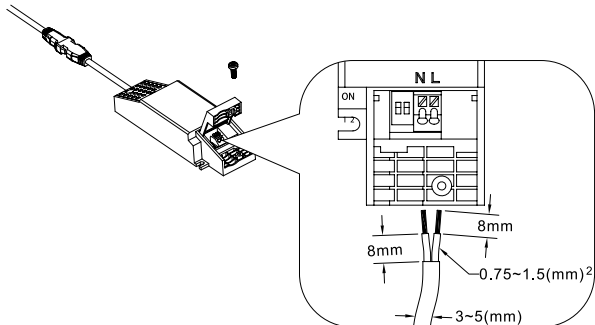

2.3 0-10V dimmable driver

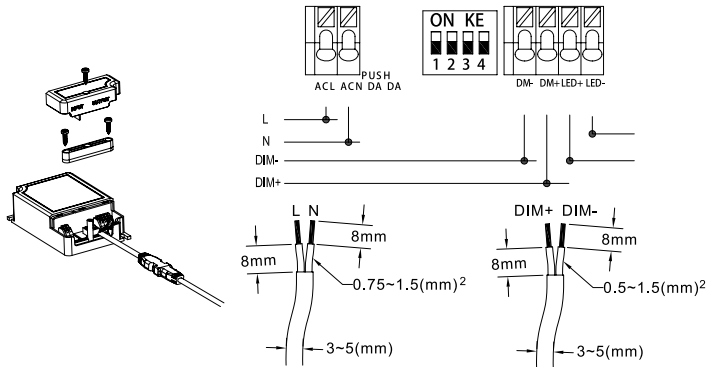

2.4 DALI dimmable driver

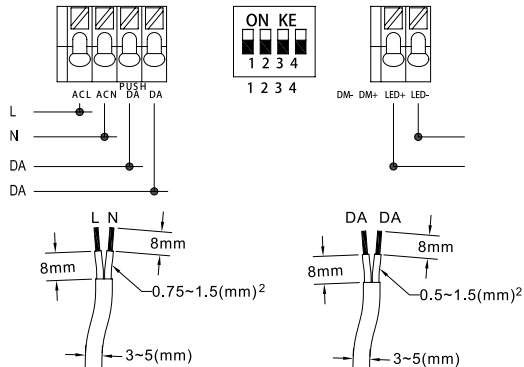

Step 3

A. Press spring clips upward

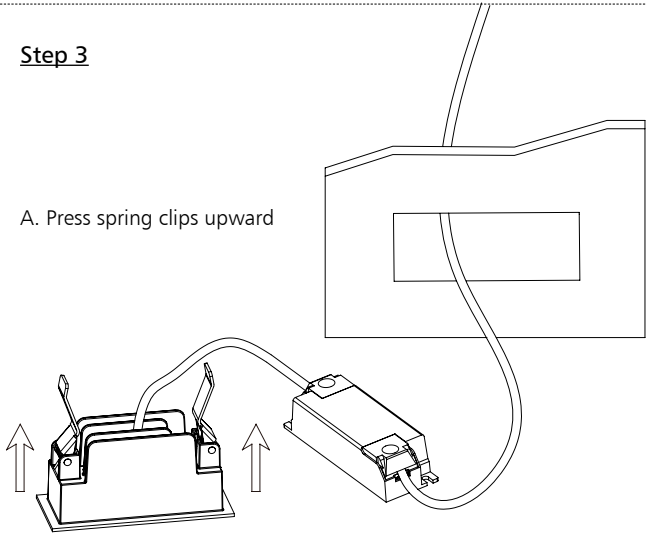

B. Push downlight into position

Step 4

Release spring clips which will hold luminaire securely

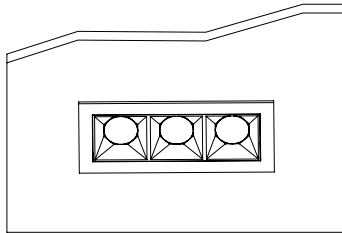

Wall washer light installation:
Install the lamps according to the distance requirements to achieve a good wall washing effect.

